



Smart Positiner

- **Smart Positiner**
- **Electro-Pneumatic Positiner**
- **Pneumatic - Pneumatic Positiner**
- **Positiner Transmitter**
- **Volume Booster**
- **Air Filter Regulator**
- **Lock up Valve**
- **Solenoid Valve**
- **Limit Switch**



Electro-Pneumatic Positiner



Electro Pneumatic Positiner  
(Dome Cover)



Pneumatic - Pneumatic Positiner



Position Transmitter



Air Filter Regulator



Limit Switch

**Other Products:**

- 1) Position Transmitter series PTM-5VL,R, PTM-6V, R (Flame proof)
- 2) Air filter regulator - VA-200 & VA-205
- 3) Volume Booster - VA 300, VA305, VA-315
- 4) Lock Up Valve - VA 400
- 5) Snap Acting Relay - VA 500, VA-505, VA-510, VA-515
- 6) Solenoid Valve - VA 700
- 7) Limit Switch - VA 850

## Smart Positioner VA-2300 Series



Model	Motion	Acting Type	Protection	Lever Type		Communication	Option
2300	<input type="checkbox"/> L Linear	<input type="checkbox"/> S Single Acting	<input type="checkbox"/> n Weather Proof	<input type="checkbox"/> 1 10~40mm	<input type="checkbox"/> 1 M6i 40L	<input type="checkbox"/> 0 None	<input type="checkbox"/> 0 None
	<input type="checkbox"/> R Rotary	<input type="checkbox"/> D Double Acting	<input type="checkbox"/> i Explosion Proof	<input type="checkbox"/> 2 20~70mm	<input type="checkbox"/> 2 M6i 63L	<input type="checkbox"/> 2 HART	<input type="checkbox"/> 1 +Transmitter
				<input type="checkbox"/> 3 50~100mm	<input type="checkbox"/> 3 M8i 40L		
				<input type="checkbox"/> 4 100~150mm	<input type="checkbox"/> 4 M8i 63L		
					<input type="checkbox"/> 5 NAMUR		



VA-2300

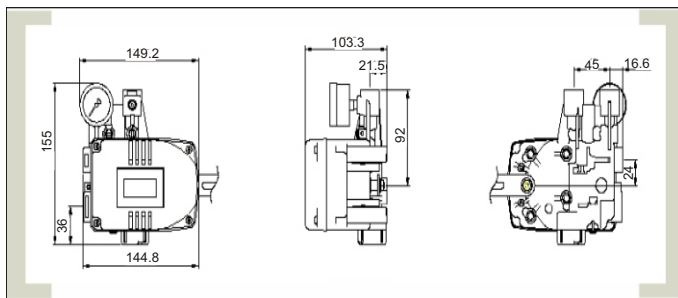

### Specifications

Item. Type	VA-2300L	VA-2300R
Input Signal	4-20mA DC	
Supply Pressure	1.4~7kg/cm <sup>2</sup>	
Stroke	10~150mm	0~90°
Impedance	Max.460 Ohm/20mA DC	
Air Connection	1/4" NPT	
Gauge Connection	1/8" NPT	
Electrical Connection	1/2" NPT	
Repeatability	± 0.5% F.S.	
Ambient Temp.	Operating	85°C Max.
	Explosion	50°C Max.
Linearity	± 0.5% F.S.	
Hysteresis	± 0.5% F.S.	
Sensitivity	± 0.2% F.S.	
Air Consumption	Bleow 2LPM	
Flow Capacity	70LPM	
Output Characteristics	Linear, EQ%, Quick Open User set (16Point)	
Material	Aluminum Diecasting	
Protection	IP66	
Explosion Proof	Ex 'd' zone 1&2 II C T6	
Weight	1.5kg (3.3lb)	

VA-2300 Smart Valve Positioner controls valve stroke accurately according to input signal of 4-20mA being input from controller. In addition, highly efficient microprocessing operator built in the product performs various and powerful functions like Auto calibration, PID control, Alarm and Hart protocol.

- LCD attached outside of the product makes to inspect the state of positioner in the field
- All kinds of information for valve and positioner can be processed by using Hart communication.
- Valve system can be stable by analog feedback signal.
- Various valve characteristics such as linear, quick open, equal percentage are available.
- PID parameters can be adjusted easily in the field only by button without communicator.

### Smart Positioner Series

- 1) VA-2300 : Aluminium Base & Cover of Valve Positioner suitable for Linear/Rotary Actuators, single & double acting Valve
- 2) VA-2350 series : Stainless steel base & cover of Valve Positioner suitable for Linear/Rotary Actuators, single & double acting Valve
- 3) VA-2301L series : Remote type unit with linear output
- 4) VA-2301R series : Remote type suitable for Rotary Actuator, single/double acting Valve. Sensor on Valve & Positioner in remote place.

## Electro-Pneumatic, Positioner VA-1000 Series



Model	Acting Type	Protection	Lever Type	Orifice Type	Ambient Temp
VA-1000	<b>S</b> Single Acting	<b>W</b> Weather Proof	<b>1</b> 10~40mm	<b>1</b> 01	<b>S</b> -20°C~60°C
	<b>D</b> Double Acting	<b>E</b> Explosion Proof	<b>2</b> 30~70mm	<b>2</b> 02	<b>H</b> -20°C~120°C
			<b>3</b> 60~100mm	<b>3</b> None	
			<b>4</b> 100~150mm		

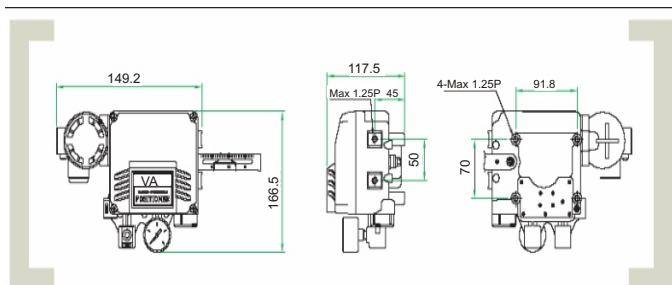

### Specifications

Item. Type	Single	Double
Input Signal	4-20mA DC	
Impedance	250i 15 Ohm	
Supply Pressure	1.4~7kg/cm <sup>2</sup>	
Stroke	10~150mm	
Air Connection	1/4" NPT	
Gauge Connection	1/8" NPT	
Conduit	1/2"NPT	
Explosion Proof	EX 'd' Zone 1&2, II C T6	
Protection	IP66	
Ambient Temp.	70°C Max. (Operating Temp.) 60°C Max. (Explosion Temp.)	
Linearity	±1%F.S.	±2%F.S.
Hysteresis	±1% F.S.	
Sensitivity	± 0.2%F.S.	±0.5%F.S
Repeatability	±0.5% F.S.	
Air Consumption	3LPM (Sup=1.4kg/cm <sup>2</sup> )	
Temp Explosion	60°C Max. (T5)/40°C Max. (T6)	
Flow Capacity	80LPM (Sup=1.4kg/cm <sup>2</sup> )	
Material	Aluminum Diecasting	
Weight	2.7kg (6.1lb)	

The Electro-Pneumatic Positioner VA- 1000 is used for operator of pneumatic linear valve actuators by means of electrical controller or control system with an analog output signal of DC 4 to 20mA or split Ranges.

- There is no resonance at 5~200Hz.
- The change RA/DA Action is convenient. it is able to apply to signal or double acting actuator.
- It is possible to prevent the hunting with orifice to the small size actuator.
- It is economical due to less air consumption.
- It is able to control the 1/2 split range with simple operation without replacement of parts.

### Electro Magnetic Valve Positioner Series :

- 1) VA-1000(Analog type) : Suitable for linear actuator for single & double acting Valve
- 2) VA-1000R Dome cover : Suitable for Rotary Actuator for single & double acting Valve with mechanical indicator
- 3) VA-1000R Dome cover : Rotary Actuator, single & double acting along with mechanical dome indicator for single & double acting Valve.
- 4) VA-1000R+PTM (internal) : Linear type Valve Positioner with internal position Transmitter, single & double acting Valve.
- 5) VA-1000R + PTM (external) : Linear type Valve Positioner with external position Transmitter for single & double acting Valve.
- 6) VA-1000R+PTM+L/S (internal) :
- 7) VA-1000R+PTM+L/S (external) :

## Pneumatic-Pneumatic, Positioner VA-1200 Series



Model	Acting Type	Lever Type	Orifice Type	Connection Type	Ambient Temp
VA-1200	<b>S</b> Single Acting	<b>1</b> 10~40mm	<b>1</b> 01	<b>1</b> PT	<b>S</b> -20°C~70°C
	<b>D</b> Double Acting	<b>2</b> 30~70mm	<b>2</b> 02	<b>2</b> NPT	<b>H</b> -20°C~120°C
		<b>3</b> 60~100mm	<b>3</b> None		<b>L</b> -40°C~70°C
		<b>4</b> 100~150mm			



### Specifications

Item. Type	Single	Double
Input Signal	0.2~1kg/cm <sup>2</sup>	
Supply Pressure	1.4~7kg/cm <sup>2</sup>	
Stroke	10~150mm	
Air Connection	1/4"NPT	
Gauge Connection	1/8"NPT	
Protection	Weather proof Ip66	
Ambient Temp.	70°C Max.	
Linearity	±1%F.S.	±2%F.S.
Hysteresis	±1% F.S.	
Sensitivity	± 0.2%F.S.	± 0.5%F.S.
Repeatability	± 0.5% F.S.	
Air Consumption	3LPM (Sup=1.4kgf/cm <sup>2</sup> )	
Flow Capacity	80LPM (Sup=1.4kgf/cm <sup>2</sup> )	
Material	Aluminum Diecasting	
Weight	1.7kg (3.1lb)	

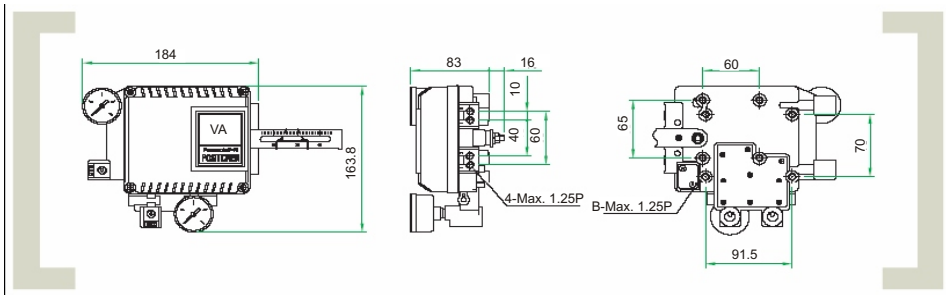

The Pneumatic positioner VA-1200 is used for pneumatic linear valve actuators by means pneumatic controller or control systems with an output signal of 0.2-0.3kg /cm<sup>2</sup> or split ranges.

- Size is compact.
- The change of RA/DA Action is convenient, it is able to apply to single or double acting actuator.
- It is possible to prevent the hunting with orifice to the small size actuator.
- It is economical due to less air consumption.
- It is able to control the 1/2 split range with simple operation without replacement of parts.

### Pneumatic to Pneumatic Positioner Series:

- 1) VA-1200 series (Linear type) Suitable for Linear Actuator for single & double acting Valve
- 2) VA-1208 series (Rotary type) suitable for Rotary Actuator for single & double acting Valve

### V. AUTOMAT & INSTRUMENTS (P) LTD.

**AUTOMAT HOUSE, F-61, Okhla Industrial Area, Phase-I, New Delhi - 110 020, INDIA**  
**Phone : 26810307, 26810280, 26816349, 26817268, 26817820, Fax : 091-11-26819440**  
**Grams : SWITCH E-mail : vautomat@airtelbroadband.in ; vautomat@vsnl.com Website : www.vautomatindia.com**

**BRANCHES IN BARODA, MUMBAI, KOLKATA, JAMSHEDPUR, SECUNDERABAD & CHENNAI**

See Website for address (Specifications Subject to change without prior notice)